

INSTALLING THE DRIVE SYSTEM

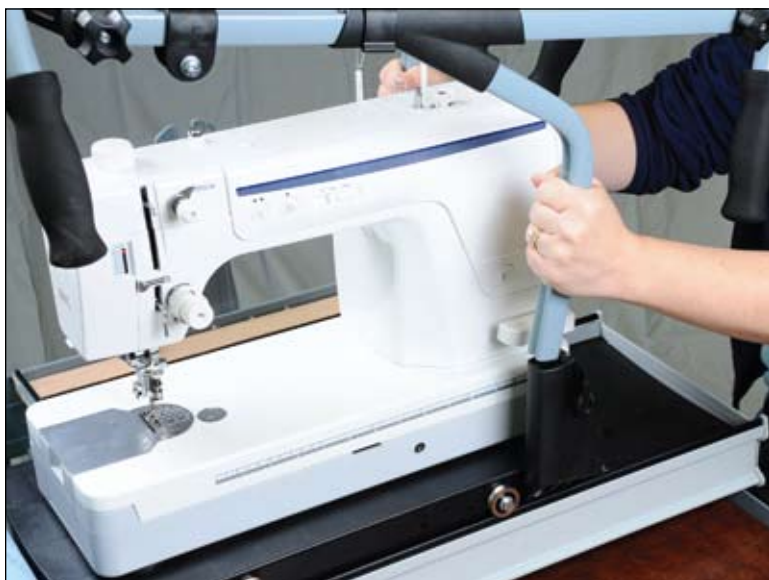

Un-snap the locks on the upper handle assembly.

NEXT GENERATION



Remove the handle assembly and set aside. Unplug all cords from the sewing machine, then lift it off of the upper carriage. Carefully place the machine in a convenient location.



If you have the Quilter's Cruise Control[®] installed, remove the optical encoders from the upper and lower carriages at this time. Re-install the bolts to secure the wheels to the carriages

INSTALLING THE DRIVE SYSTEM

NEXT GENERATION | INSTALLING THE DRIVE SYSTEM

For best performance of the QBOT, please replace all eight (8) wheels with steel wheels. If you already have steel wheels, then you do not need to replace them. If you have any questions, please contact your dealer.



Using the 4 mm hex key, remove the two bottom screws from the back side of the lower carriage. You will not use these screws again. Set them aside with other parts that will not be reused.

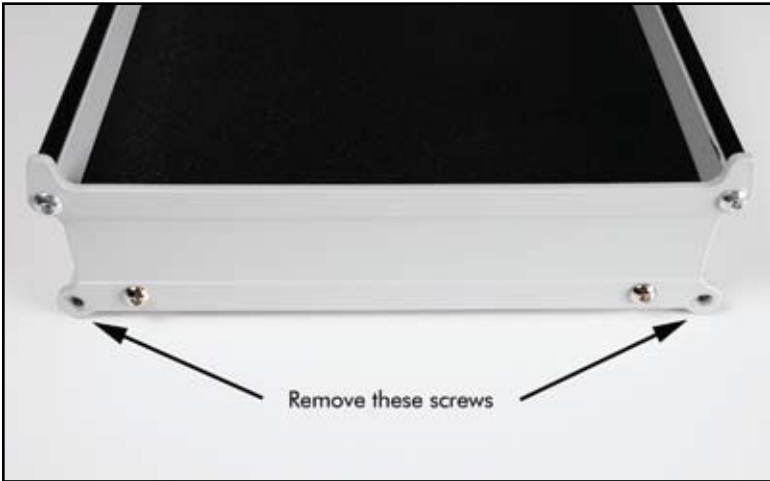

Mount one of the QBOT drive assemblies to the back of the lower carriage using two 1½" button head screws provided. Make sure the drive assembly is secure by tightening the screws with the hex key.



INSTALLING THE DRIVE SYSTEM



Attach the second drive assembly to the right hand side of the upper carriage as viewed when you are standing at the back of the frame. Set the upper carriage on its side with the handle holder of the carriage on the left. Remove both bolts and metal wheels from the right side. Set aside the wheels to be used later. The bolts and washers that were removed will not be reused.

NEXT GENERATION



Place one 1½" button head screw through the hole of the drive assembly, replace one metal wheel, then slide on a washer from the QBOT installation hardware pack. Insert into the rear hole in the upper carriage and screw gently into the original nut that is in the upper carriage. Do not tighten at this point.



Next, place the second 1½" button head screw into the slot in the assembly. Slide on a washer from the QBOT installation hardware pack, metal wheel, and 3rd washer. Insert into the upper carriage and screw gently into the original nut. Securely tighten both screws after the assembly is in place on the carriage.



INSTALLING THE DRIVE SYSTEM

NEXT GENERATION INSTALLING THE DRIVE SYSTEM

Install the 24" upper drive wire to the lower carriage. You will need the following within reach when you begin this installation: 2 Y-axis wire holders, 24" wire, 4 mm hex key, one tensioner and tensioning template (found on last page of this manual.)



Remove the upper right-hand screw that is above the drive assembly. Keep this screw handy. Attach one Y-axis wire holder and replace the screw you just removed. Tighten securely, making sure that the hook on this wire holder is in the 5 o'clock position.



Remove the second screw that is at the top of the opposite end of the lower carriage on the same side. Attach the second Y-axis wire holder and replace the screw. Tighten securely ensuring that the hook on this wire holder is in the 7 o'clock position.



INSTALLING THE DRIVE SYSTEM

INSTALLING THE DRIVE SYSTEM



Take one end of the 24" wire and place the eyelet around the hook of the Y-axis wire holder on the front of the lower carriage.



Rest the upper carriage onto the drive assembly near the lower carriage. Place the drive wire over the top of the drive pulley **wrapping twice** around the drive wheel in a **clockwise** direction.

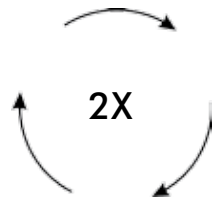

Holding the wire taut with your hand, return the carriage to its upright position on top of the lower carriage.

Attach the eyelet of the wire to the tensioner. Attach the other end of the tensioner to the hook of the Y-axis wire holder.



Move the upper carriage all the way to the front of the lower carriage. Tighten the wire with the center of the tensioner until it is stretched like a guitar string.



Use the tensioning template as your guide for tightness. The wire should move approximately 1/8 to 1/4 inch as you push on it.

The upper drive wire is now installed!

INSTALLING THE DRIVE SYSTEM

NEXT GENERATION **INSTALLING THE DRIVE SYSTEM**

You are now ready to install the lower drive wire. Use similar steps as with the upper wire.

Gather the following within reach: 2 X-axis wire holders, 4 mm hex key, 60" or 120" wire (depending upon your frame length), one tensioner and tensioning template. Keep the wire that you don't use in a safe place in case you change the length of your frame.



Standing at the back of your frame, loosen slightly the upper left hand screw using the hex key.

Slide the X-axis wire holder, labeled 'L', between the frame and the screw head. Tighten the screw securely.

Loosen slightly the upper right hand screw, slide the X-axis wire holder labeled 'R' between the frame and the screw head. Tighten securely.



INSTALLING THE DRIVE SYSTEM



Take one end of the lower drive wire and place the eyelet around the hook of the right X-axis wire holder.

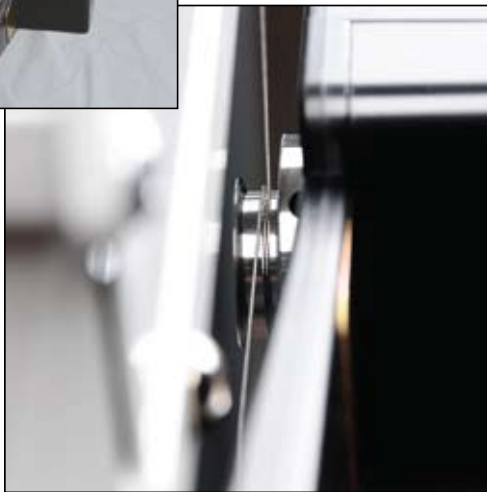

Lift the whole carriage unit off the rails and move slightly to the back of the frame. Standing at the back of the frame, place the lower drive wire over the drive pulley, **wrapping down and around twice**. Holding the wire taut with your left hand, return the carriage back to the rails of the frame. The photo to the left is a view looking down on the drive assembly.

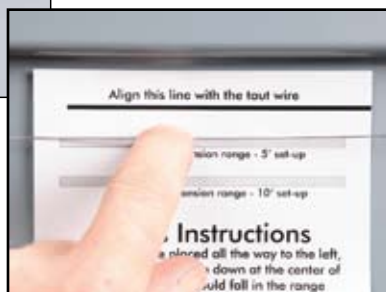

Attach the tensioner to the hook of the left X-axis wire holder. Attach the eyelet of the wire to other end of the tensioner. Tighten the wire with the center of the tensioner until it is stretched like a guitar string. Use the tensioning template as your guide for tightness as before.

INSTALLING THE DRIVE SYSTEM

NEXT GENERATION INSTALLING THE DRIVE SYSTEM

Move the carriage back and forth to ensure the wheels are riding on their tracks.

Place your sewing machine back on the carriage and replace the handle assembly.

The QBOT drive system is now installed.

Remove the black knob from the front center of the handle assembly. Slide the QBOT bracket onto the exposed bolt. Replace and tighten the black knob to hold your QBOT in place. Notice the QBOT bracket is adjustable so that you can move the QBOT to easily see the screen in any light.

